



52 Manchester Road GYMEA NSW

3  2  1 

Conveniently positioned and immaculately presented this townhouse offers a low maintenance lifestyle with a sunny North facing paved courtyard in a well cared for block. Well located within footsteps of popular Gymea Shopping Village and Station.

Open plan lounge & kitchen, huge sky light ceiling with retractable blinds.

Stone kitchen includes stainless steel appliances, glass splashback & dishwasher.

Three spacious bedrooms, main includes private balcony. Contemporary two way bathroom downstairs & second bathroom upstairs.

Sunny North facing courtyard with timber bench seating & retractable awning.

Well thought-out laundry space behind kitchen.

Remote controlled one and a half car garage with easy access into complex.

View : <https://www.cronullarealestate.com.au/lease/nsw/sutherland/gymea/residential/townhouse/5720938>



Property Management Team
02 9523 9422

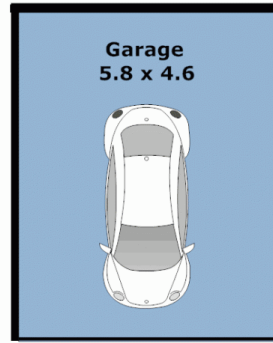
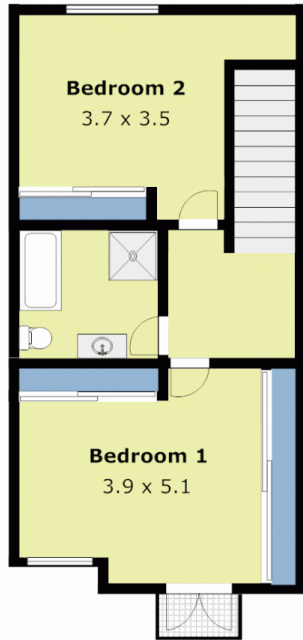
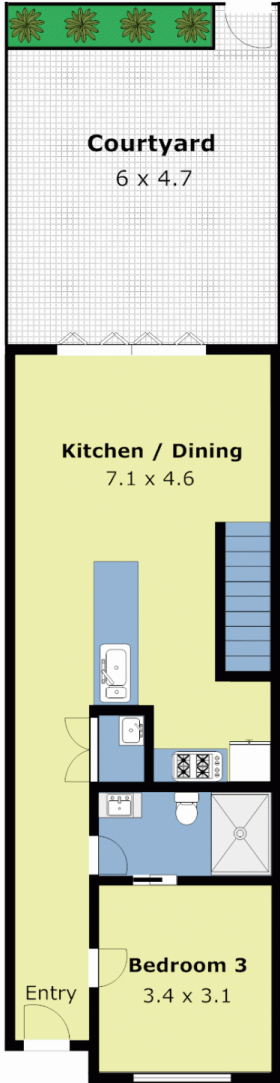

Cronulla
real estate

6/52 Manchester Road, Gymea

DISCLAIMER: PLANS SHOW ARE FOR PRESENTATION AND ARE NOT PART OF ANY LEGAL DOCUMENT. ALL MEASUREMENTS AND FIGURES ARE APPROXIMATE.