



**4/49 Karimbla Road Miranda NSW**

2  1  1 

Practical, well designed and positioned in a small complex of 5, this townhouse has been renovated throughout and is a great opportunity for first home buyers, downsizers and investors alike. Convenient and centrally located between Sutherland Hospital and Westfield Shopping Centre.

- Modern kitchen features stone bench tops, breakfast bar, with ample cupboard and bench space
- Spacious open plan living/dining flowing to outdoor entertaining patio
- Generously sized bedrooms both with built-in wardrobes
- Family bathroom with separate bath & shower, floor to ceiling tiles
- Downstairs laundry with second toilet
- Private and sunny level grassed backyard

[For full version visit the website](https://www.cronullarealestate.com.au)

**Type** : Townhouse  
**Price** : \$ 1,055,000  
**Building Size** : 155 sqm  
**View** : <https://www.cronullarealestate.com.au/sale/nsw/sutherland/miranda/residential/townhouse/8124429>

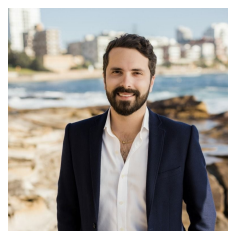

**Corey Bell**  
02 9523 9422



**Jake Whittaker**  
02 9523 9422

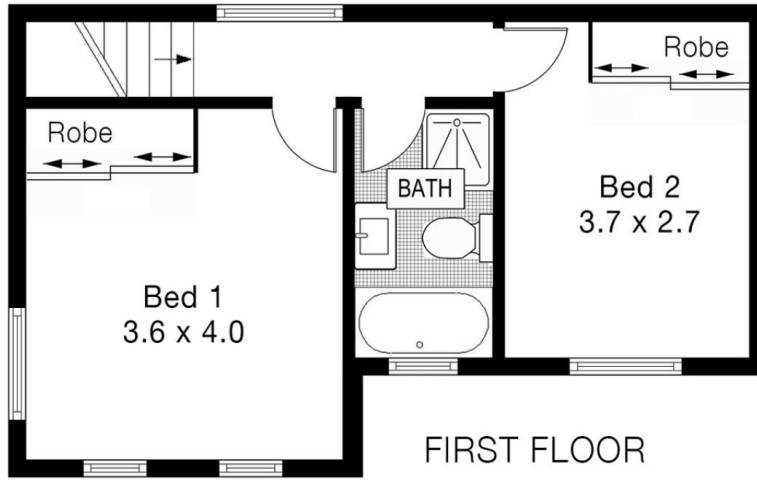

## 4/49 Karimbla Road, Miranda

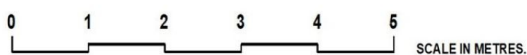

Scale in metres. Indicative only. Dimensions are approximate. All information contained herein is gathered from sources we believe to be reliable. However we cannot guarantee its accuracy and interested persons should rely on their own enquiries.